

SPECIALTY APPLICATIONS

Whether your need is large scale coolers, processing rooms or storage facilities, KPS Global® insulated panel systems are modular for ease of assembly with interlocking tongue-and-groove perimeter panels. Panels are available in 3½", 4" and 5" thickness and can be designed for indoor or outdoor applications. In addition, panels can span up to 26' without any additional support in most indoor applications. Double bulb compression gaskets are standard, and panels are made of solid core, poured-in-place urethane insulation (with a density of 2.2 pounds per cubic foot) to ensure superior performance and low operating costs. The urethane also meets the ignition properties requirements of ASTM D-1929 and is CFC free.

Our in-house engineering teams can design steel infrastructure to support taller designs or load requirements for outdoor units. By utilizing the cam-lock system, installation time is greatly reduced compared to mechanically-fastened panel systems. Panels can be designed to meet NSF and USDA approved specifications.

Not only can KPS Global panel systems be used for smaller scale, multi-compartment cold storage rooms but they can also be for a variety of applications including:



- Ultra-Cold Test Freezers
- Emergency Shelters
- Fishing Shelters
- Blood Plasma Storage
- Partition Walls for Processing Facilities
- Hunting Blinds
- Necropsy Rooms
- Horticulture
- Sound Attenuation

Other large-scale applications include breweries, food banks, central kitchens and processing facilities.

WHY KPS GLOBAL?

State-of-the-art manufacturing and expert design assistance ensure our products meet or exceed the demanding specifications and quality expectations of the industrial market. KPS Global employees are customer focused to ensure a successful project.

With manufacturing plants located strategically across the country, KPS Global offers you peace of mind for production redundancy and reduced shipping costs as well as short lead times.



BENEFITS

- In-house Design
- Engineering Expertise
- Flexible/Modular Construction
- Custom specifications
- Heavy Duty Construction
- In-Facility or On-Site Assembly
- Short lead times



PANEL CONSTRUCTION

KPS Global insulated panels are constructed of either Wood or **INSULFRAME™** High-Density Rail (HDR) urethane frames in 3½", 4" or 5" thickness. Panels are fastened with the cam-lock system to ensure a tight seal. Metal clad surfaces, designed to your specifications and with tongue and groove frames, are joined with a cam-lock that allows for easy and fast on-site modular assembly.

CAM-LOCK (UNLOCKED)

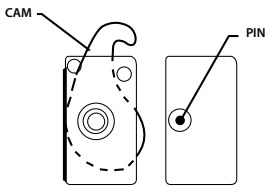

CAM-LOCK (LOCKED)

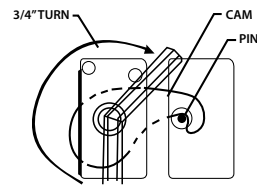

CEILING ASSEMBLY OPTIONS

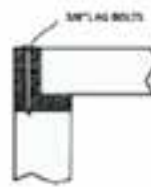

Ceilings are fastened using a lag down assembly although a cam-lock system is also available.

PANEL JOINT COMPONENTS

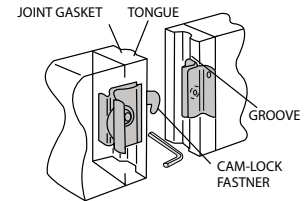

In addition, KPS Global offers OEM components such as refrigeration, lighting, shelving and doors to complete the project. With installation services, your project can be handled entirely by KPS Global to make the process seamless.



DISPLAY DOORS

From floral arrangements to beverages, specs can include:

- Anti-fog glass
- Specific humidity controls
- And more!



TRAFFIC DOORS

Fast, affordable two-way movement solution tailored to meet:

- Variety of applications
- Functionality goals
- Cosmetic needs



MANUFACTURED DOORS

Custom-made swing doors and door sections:

- Can replace any brand walk-in door
- Come with variety of trims, wiring, finishing parts
- Ship 5-7 days from approval



ALARMS/CONTROLS

Protect equipment and promote energy savings! Demand defrost controls for walk-in coolers and freezers:

- Provide efficient temperature/defrost control
- Factory-mounted or retrofitted alarms/alerts
- Can be monitored on or offsite



SHELVING

Variety of efficient shelving systems to maximize cooler/freezer storage. Custom configured systems include:

- Gravity-fed shelving
- Movable shelving carts
- Adjustable flat shelves



ASSET PROTECTION

Protect walk-ins from damage or wear and tear.

- Bollards protect impact points, corners
- Box rail outside/inside box
- Protects sliding door
- Shock absorption minimizes floor damage



REFRIGERATION

Cooling units from ½ HP to 80 HP to fit any size project:

- In-house experts with 100 years sizing experience
- Competitive pricing from multiple manufacturers
- Components arrive together



LIGHTING

Don't worry, let our knowledgeable parts experts help you decipher:

- Lumen Output
- Efficacy
- Illuminance
- Voltage, and more
- Foot Candles
- And more!



NET BARRIER SYSTEMS

Fall protection/safety netting:

- Prevents falls
- Keeps workers safe